



이화산업사
LEEHWHA INDUSTRY CO.

User Manual

Corn Milling & Sorting Machine

LHP-200CM

Rev. 1.0

Before using this product, be sure to read the user manual carefully for safe and proper use.
Keep this manual in an easily accessible location for future reference.

Introduction

This user manual describes how to use and maintain the Corn Milling & Sorting Machine LHP-200CM. All information in this manual including drawings is based on the original time of publication, and some features and specifications may be subject to change without notice. Please contact us regarding any missing or unclear information.

When renting out or transferring ownership of this device, be sure to include the user manual. If the manual is lost or damaged, please order a new one.

© 2019 Lee Hwa Industry Co.

■ Labels Used in this Manual





 Danger	Failure to follow instructions marked with "DANGER" may result in death or serious injury to the user.
 Warning	Failure to follow instructions marked with "WARNING" may result in serious injury to the user.
 Caution	Failure to follow instructions marked with "CAUTION" may result in minor injury to the user and damage to the equipment.
 Notice	Additional useful information is marked with "NOTICE".

Table of Contents

Introduction	4
Product Specifications	4
Names of Components	5
Safety	7
Warning Label Locations	7
Warnings	8
Precautions	8
Installation	9
Before Using	9
Usage	10
Troubleshooting	12
Maintenance	13
Consumables	13
Long-term Storage	18
Warranty	19
Limitation of Liability	19

Introduction

This device separates corn from its husk, grinds the kernels, and expels the ground kernels after separating them into 3 kinds of thickness.

Product Specifications

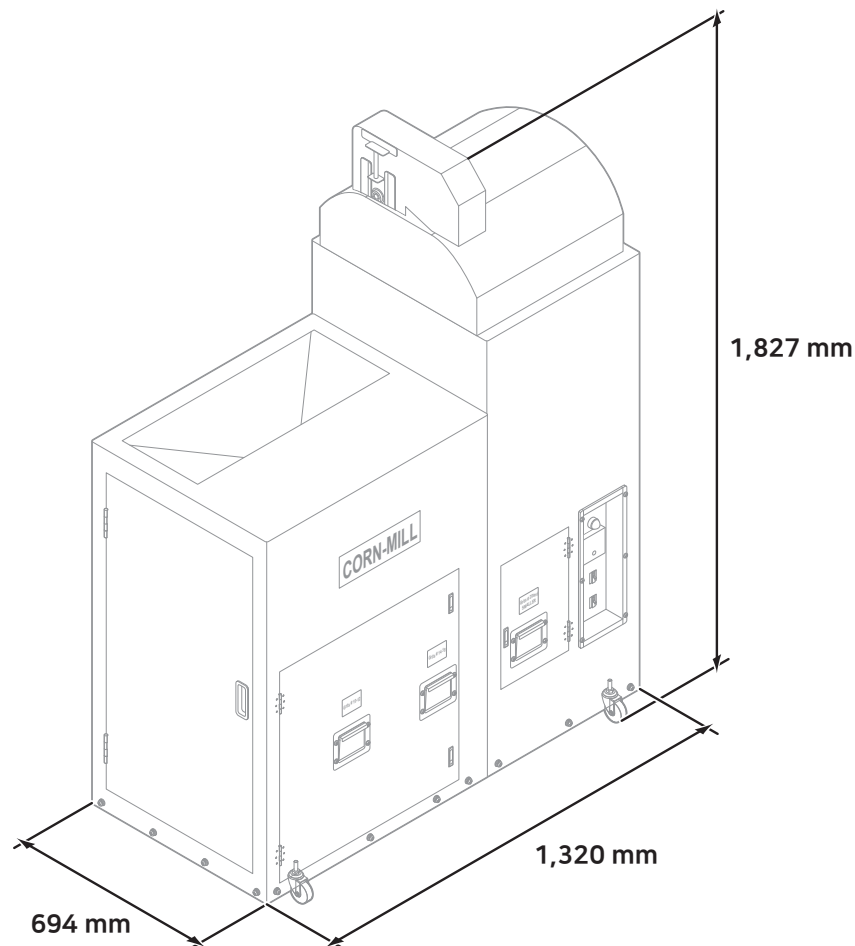

Item	Specifications	Item	Specifications
Name	Corn Milling & Sorting Machine	Model Name	LHP-200CM
Body	<ul style="list-style-type: none">Length: 1,320 mmWidth: 694 mmHeight: 1,827 mm	Weight:	330 kg
Operating Voltage	220 V	Power Usage	4.4 kW (2.2 kW × 2)
Wire Specifications	VCTF 6.5S Q	Output	200 kg/h
Drive Motor	<ul style="list-style-type: none">Model Name: SE-2000Type: Single-phaseRotations: 1,750 rpmOperating Voltage, Power: 220 V, 4.4 kW	Miscellaneous Equipment Rotation Count	<ul style="list-style-type: none">Mill: 2,349 rpmSorting screen: 494 rpmPolisher: 959 rpmFan: 4,654 rpm

Names of Components

Product Exterior

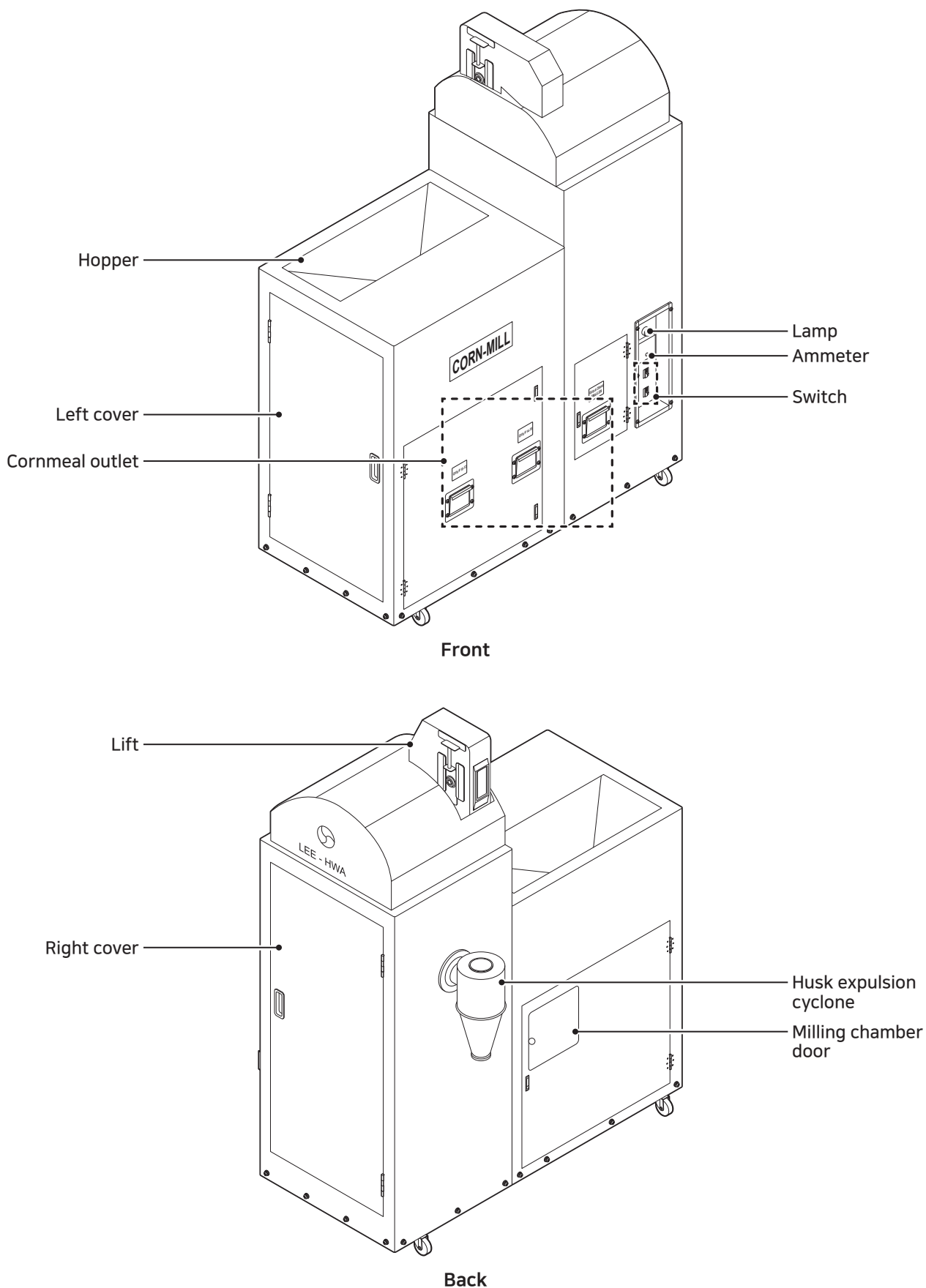



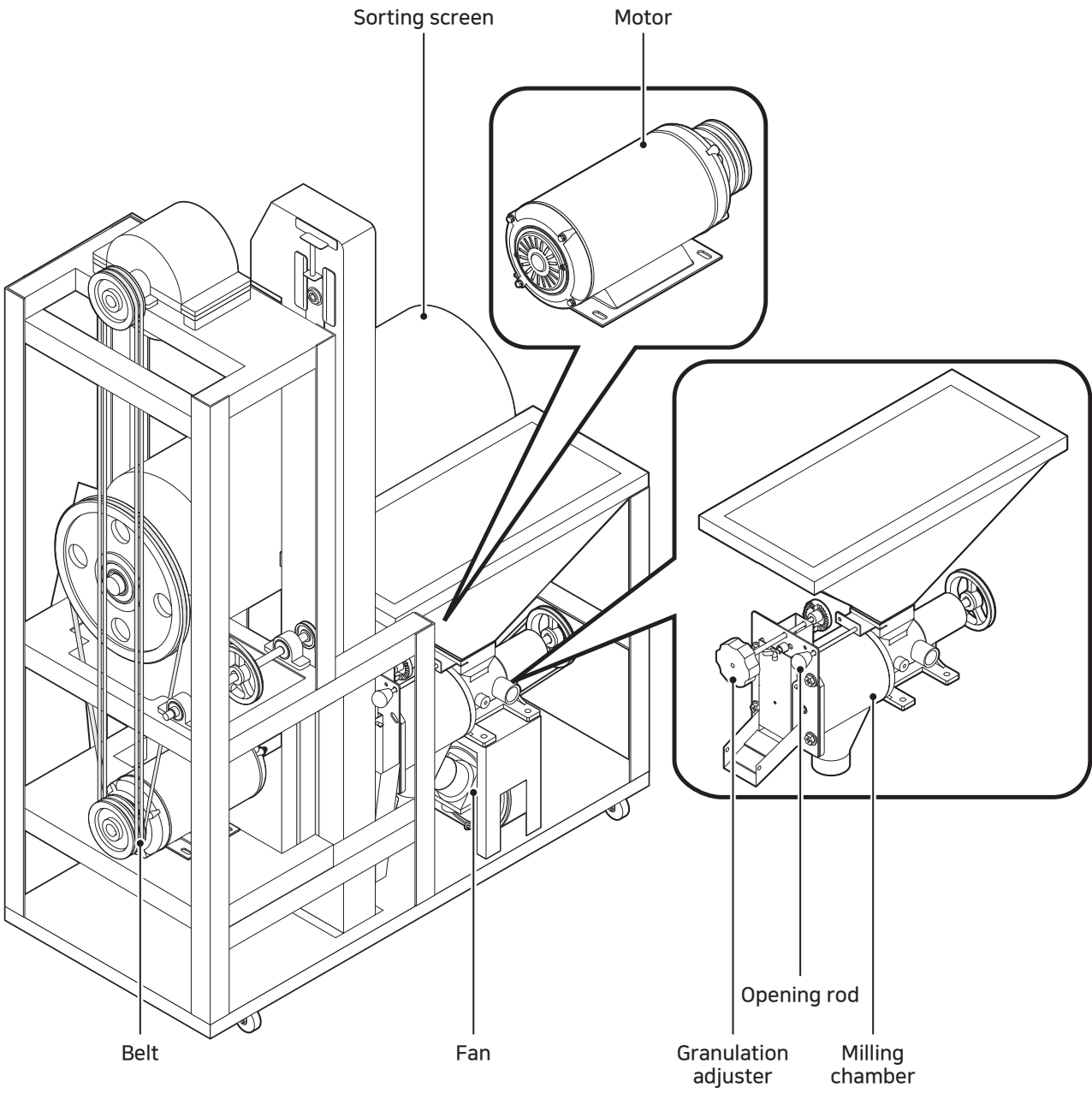

Product Interior



Safety

Warning Label Locations

Various warning labels are attached to potentially dangerous locations on the product. Be familiar with the various kinds of labels and the varying categories of danger and be sure to adhere to each label's instructions.

No	Label	Content
1		Do not touch under any circumstances.
2		Do not open the cover while the product is operating under any circumstances. Your hand may be injured by the moving parts.
3		Be careful not to operate the machine with wet hand. This may cause electric shock.
4		Please connect the earth bar to the ground and put to earth.

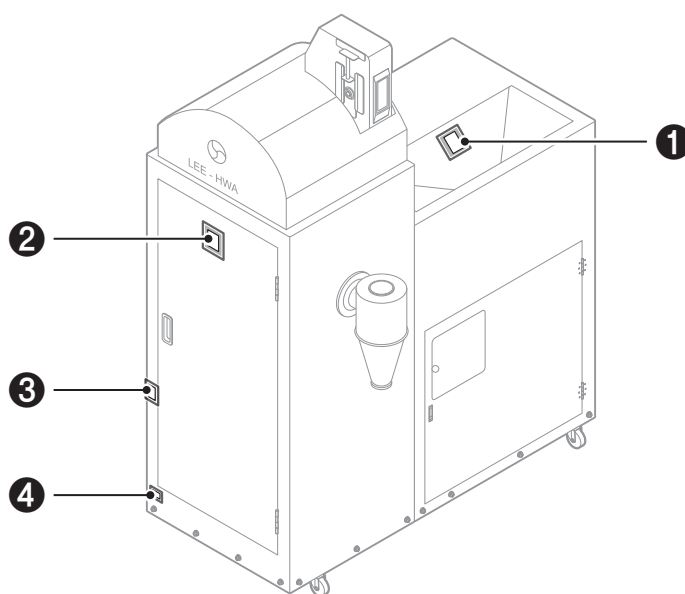
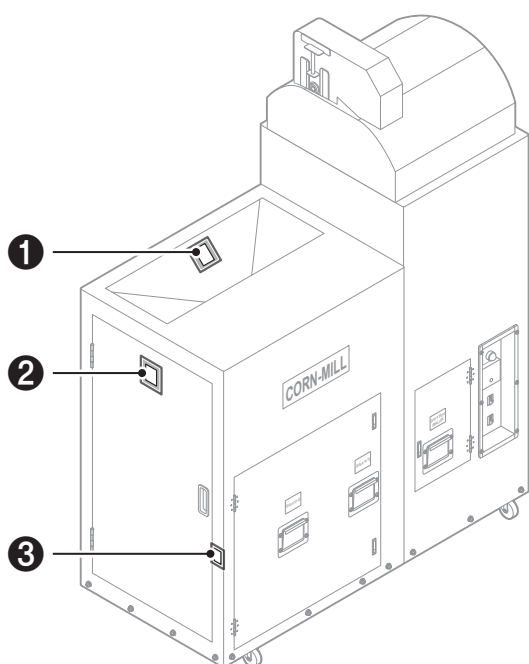

Warnings



Warning

Failure to follow instructions marked with "WARNING" may result in serious injury to the user.

- While the device is operating, do not open the cover or place hands inside the device.
- Make sure that children are kept away from the device.
- Do not operate the equipment with wet hands.
- Use a grounding rod to ground the device.
- Do not bend or break the power cord of the equipment.

Precautions



Caution

Failure to follow instructions marked with "CAUTION" may result in minor injury to the user and damage to the equipment.

- When the equipment is not in use, disconnect the power by using a ground fault circuit interrupter.
- Do not install the equipment directly in water or in a humid place.
- Do not move the equipment while it is operating.
- Do not place heavy objects on top of the equipment.
- When operating the device, avoid wearing baggy clothing and wear simple attire.
- Use the equipment for its intended purpose only.
- Do not attempt to modify or disassemble the equipment.
- Do not insert foreign materials into the device.
- Only insert corn that has undergone drying and careful selection.
- When adjusting granulation, ensure that the ammeter does not exceed 22 A.
- Regularly clean parts marked with cleaning instruction labels.
- Regularly clean the device interior.
- Regularly check the belt tension.

Installation

Install the equipment in a proper location by adhering to the following:

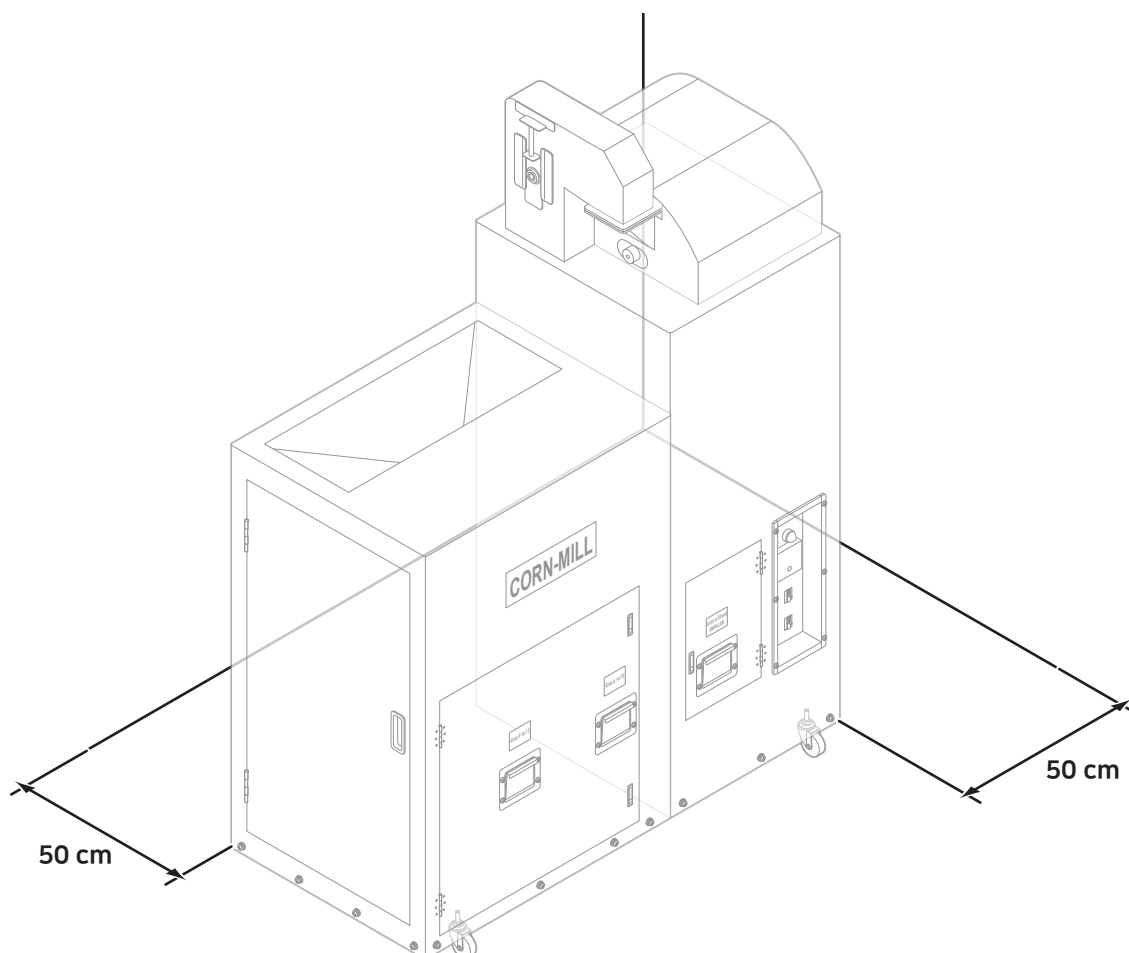

- Install the device so that users have ample space to approach from the front and back.
- Install in a well-ventilated and dry place.
- Install the equipment on a flat and solid surface.

Before Using

1. Attach the husk expulsion cyclone on the back of the device and place a sack or basket under the cyclone to catch the husks.
2. Push in the opening rod to close.
3. Turn the granulation adjuster to adjust fineness.
The higher the number, the more fine the granulation.
4. Plug in the equipment.



Warning

- Ensure that the device is connected to the ground fault circuit interrupter.
- Use a grounding rod to ground the device.
- Check the product specifications, then select switches and wires of appropriate thickness when installing the device.

Usage

1. Insert corn into the hopper and place a sack or basket in front of the cornmeal outlet.



Caution

Only insert corn that has undergone drying and careful selection.

2. Pull the cornmeal outlet cover to open.

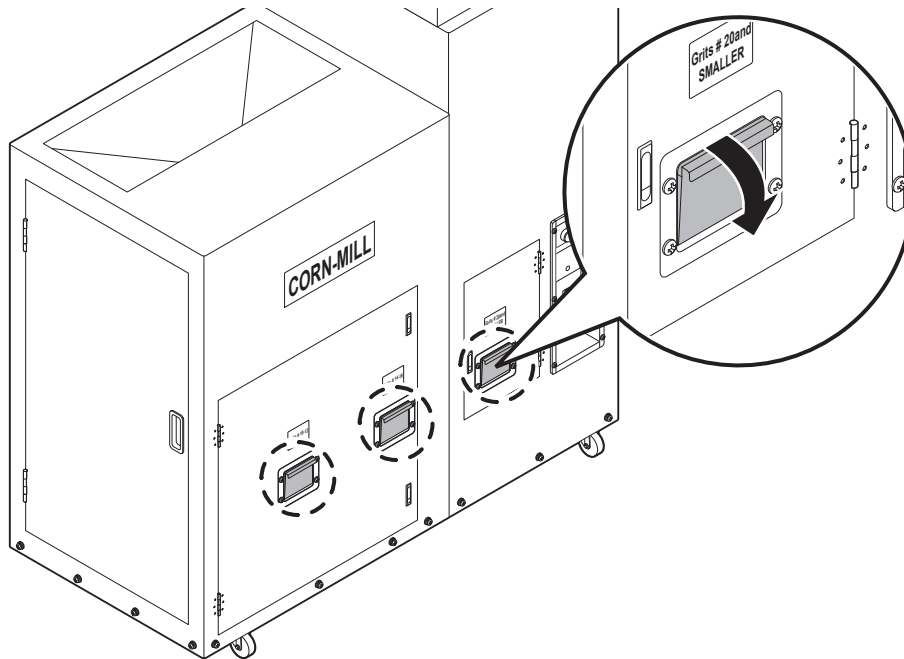

3. Flip the two switches on the dashboard upwards to turn them on.

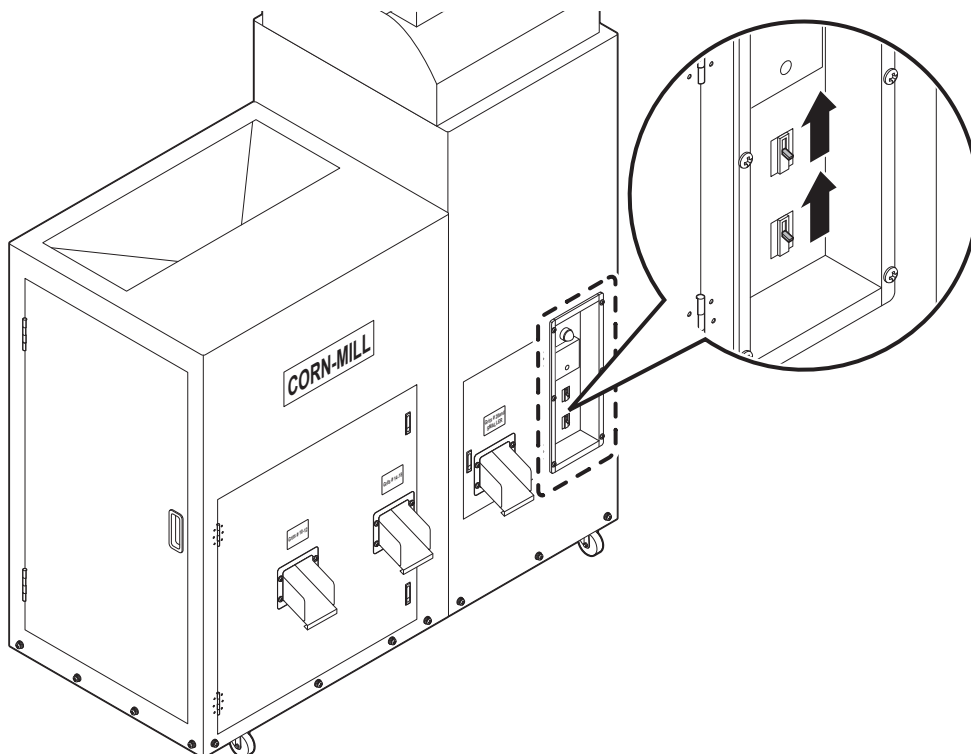

4. Open the milling chamber door at the back of the device. Turn the granulation adjuster to adjust fineness.

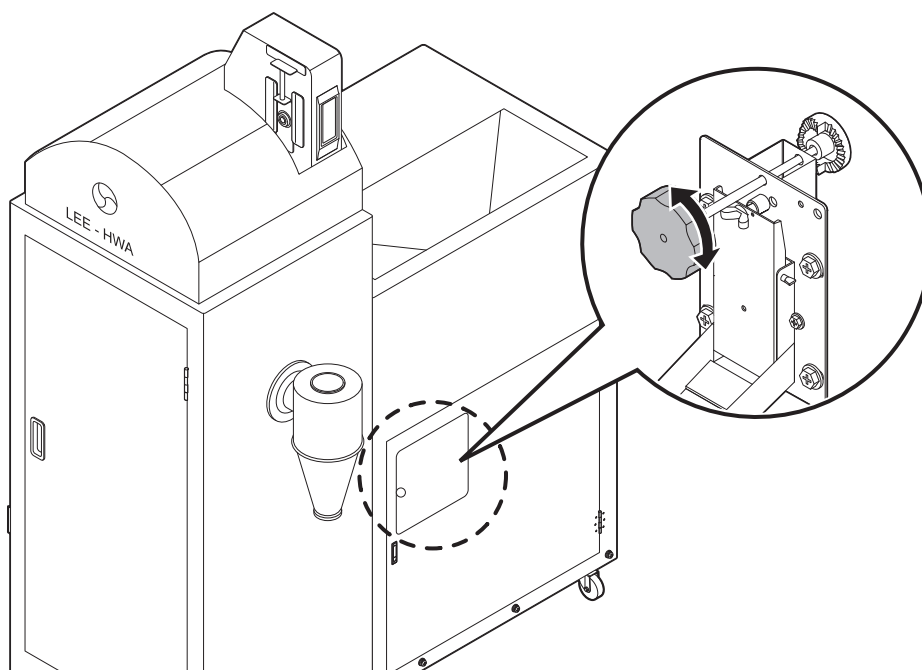

When adjusting granulation, ensure that the ammeter does not exceed 22 A.

5. Pull the opening rod to open.

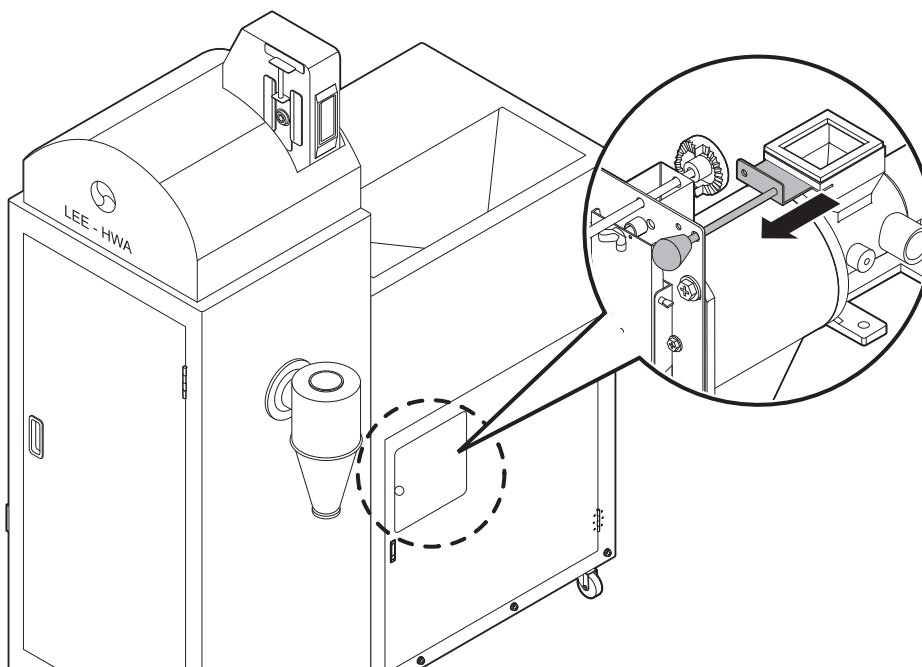

6. Once milling is completed, let the device idle and expel all remaining corn from the device.

Troubleshooting

Attempt the suggested solutions for the encountered problem in the order dictated below until the problem is resolved. If the problem persists after attempting all suggested methods, please contact us.

Machine is making noise while switches are off

- Foreign substances may be caught in the device. Remove any foreign substances.
- Kernels may be caught in the milling chamber screen. Clean the inside of the milling chamber screen.
- Corn may have a high water content. Check the corn hydration level and/or that the correct corn was selected.
- Check the belt tension.

Machine is making noise while the motor is not running

- Foreign substances may be caught in the motor pointer. Contact a professional to take the motor apart and clean it.
- Power may have been cut off from the device. Plug in the device.

Loud noises during use

- Foreign substances may be caught in the device. Remove any foreign substances.
- The bearing may be worn out. Replace the bearing.
- Nuts may be loose. Screw in the nuts.

Corn husks are not being separated from the kernels

Fan blades may be worn out. Replace the fan blades.

Different sized kernels are mixed with cornmeal

- The sorting screen may be worn out. Replace the sorting screen.
- The sorting screen brush may be worn out. Replace the sorting screen brush.



Warning

A licensed, professional technician must replace the sorting screen or sorting screen brush and abide by the local regulations.

Maintenance

Perform all maintenance procedures with both the equipment and the power turned off.

Consumables

Check the condition of the following consumables and replace when appropriate.

- Consumable replacement period may change depending on conditions of use.
- Belt, bearing and other consumables must be purchased from the manufacturer.

Consumables	When to Replace
Fan blades	<ul style="list-style-type: none"> • Husk and kernels are not properly separated • Blade is worn out by more than half.
Milling chamber screen	<ul style="list-style-type: none"> • Kernels emerge mixed with husks • Ammeter value does not go up and the quantity of expelled corn is small.
Sorting screen	Different sized kernels are mixed with cornmeal
Sorting screen brush	Different sized kernels are mixed with cornmeal and/or quantity of expelled corn is small.
Belt (Grade: A35, B57, A66, A43, B87, B56)	Device does not work properly.
Bearing (Grade: F207, P207, P206, 6208)	Device does not work properly.



Warning

A licensed, professional technician must replace the sorting screen or sorting screen brush and abide by the local regulations.

Replacing Fan Blades

1. Open the cover at the back of the device.

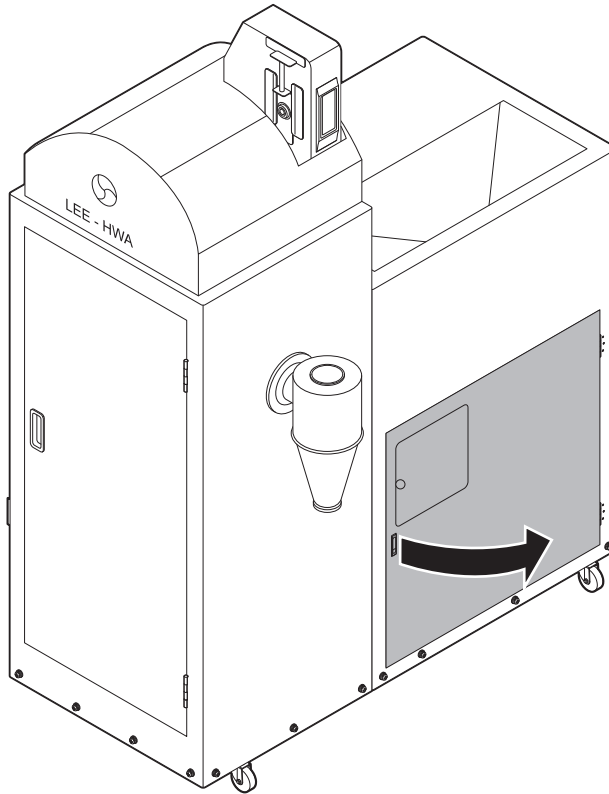

2. Remove the fan cover.

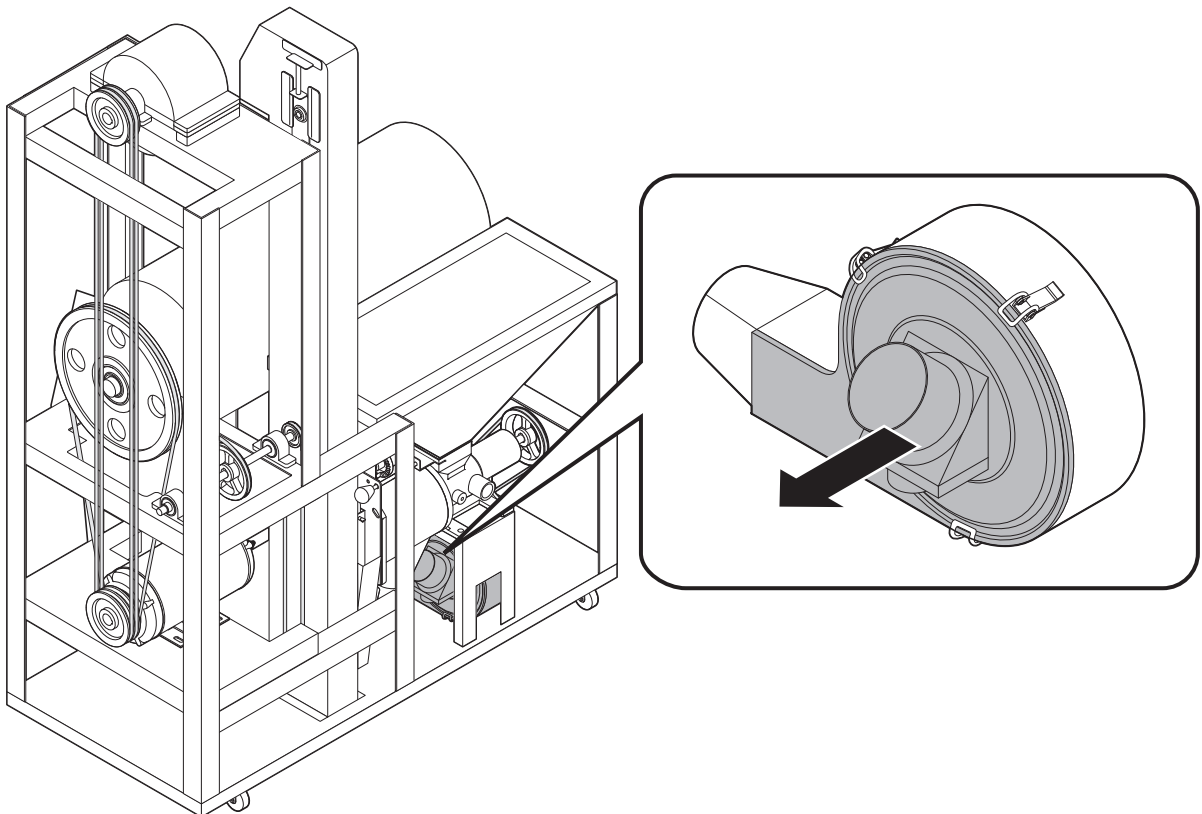

3. Remove the fan blade by turning the left screw nut holding the blade in place clockwise.

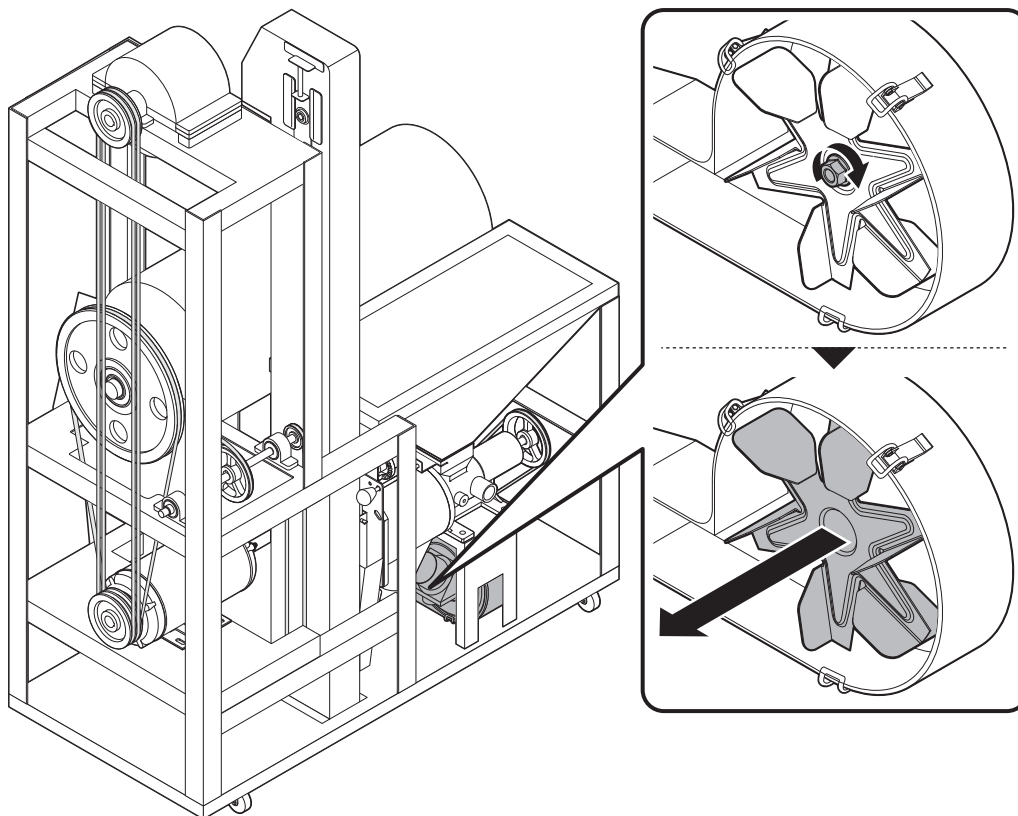

4. Replace the fan blade and reassemble following the above order in reverse.

Replacing Milling Chamber Screen

1. Open the cover at the back of the device.

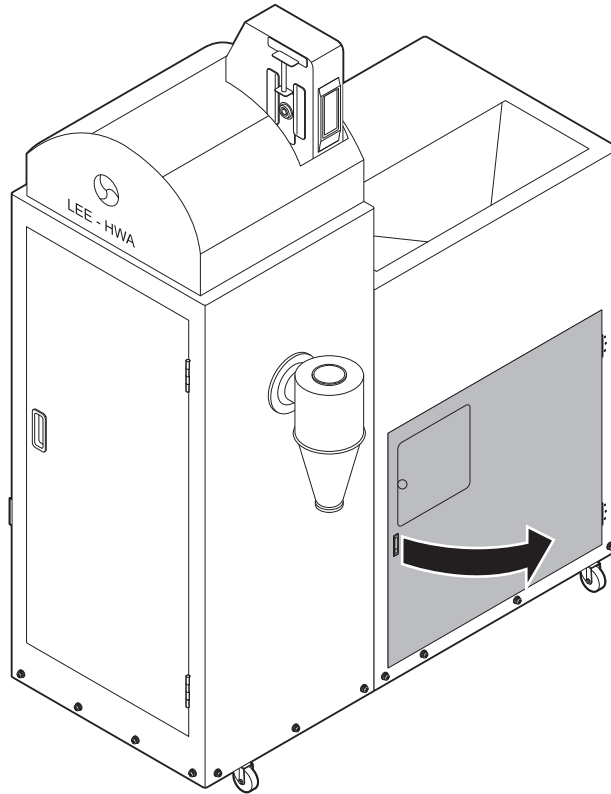

2. Remove the 4 (8 mm) bolts at the milling chamber grain exit panel.

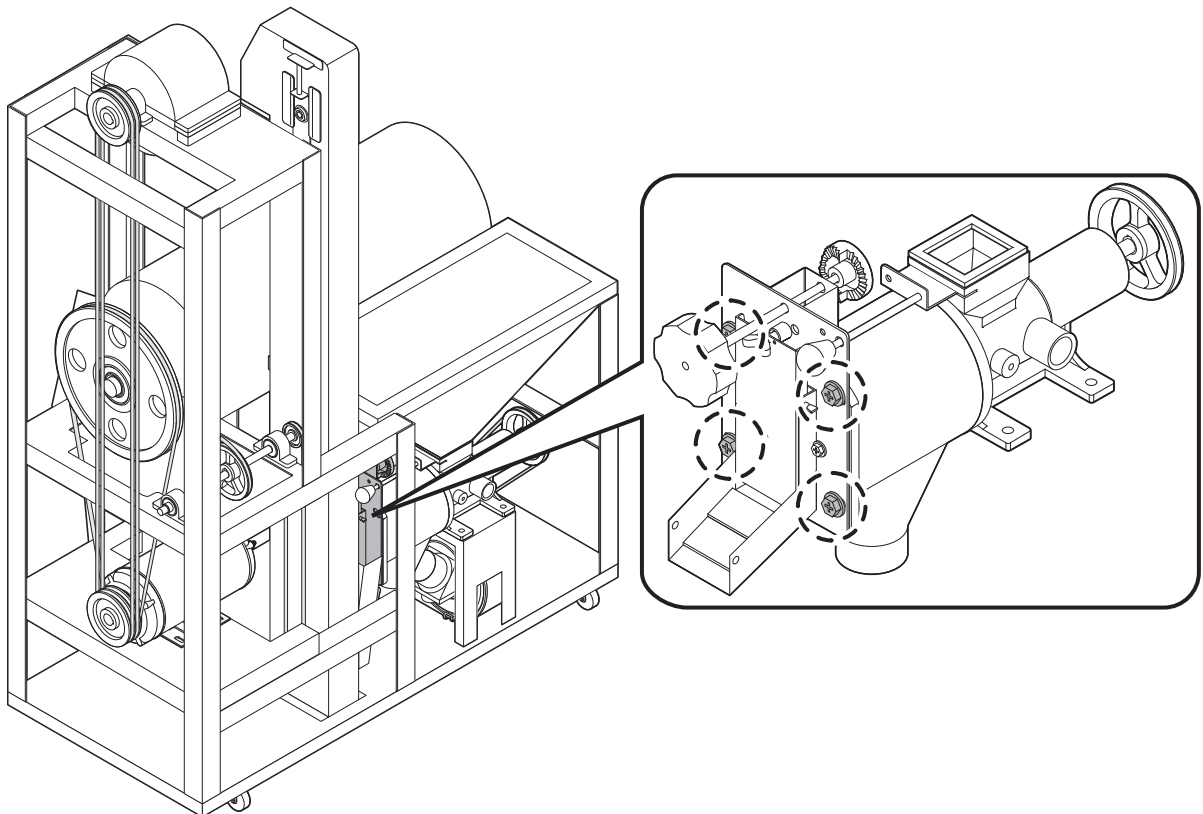

3. Pull the granulation adjuster. The milling chamber screen and holder will come out.

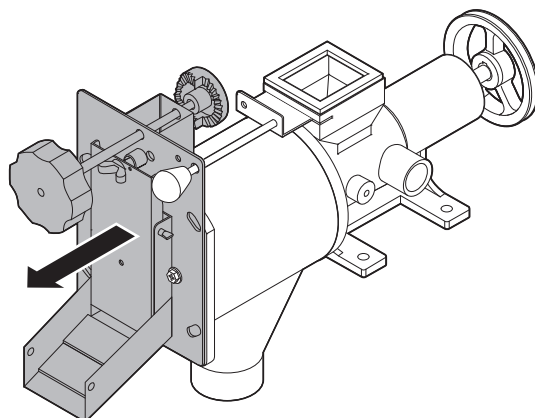

4. Remove the 2 (6 mm) bolts from the grain exit panel and separate the panel from the holder.

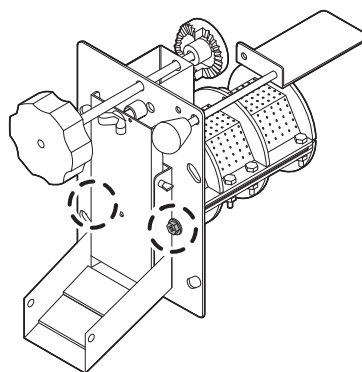

5. Remove the screws from the holder that are securing the screen.

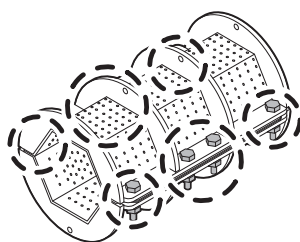

6. Replace the screen and reassemble the holder.
7. Reassemble following the above orders in reverse.

Long-term Storage

If the equipment will not be used for a long period of time, store it properly according to the following procedure:

- Turn all switches off and disconnect the power source.
- Push the opening rod and cornmeal outlet cover to close.
- Clean the hopper, cyclone, cornmeal outlet, etc., to ensure that no cornmeal is remaining in the device.
- Before storing, check the belt tension.
- Before storing, check if the milling chamber screen and the sorting screen are worn out.
- Before storing, let the machine idle so that it may expel any remaining corn.
- If paint is peeled or exposed, apply new paint or lubricant to prevent rust.
- Store in a well-ventilated and dry place.
- Do not store in a humid place.
- Keep on a flat surface.

Warranty

Within one year of the purchase of the equipment, Lee Hwa Industry Co. will pay the cost of replacement parts and labor needed to repair equipment that breaks during normal use.

Limitation of Liability

The warranty does not apply in the following cases:

- Equipment failure caused by unpermitted use
- Equipment failure caused by user negligence such as corrosion, dropping and fire.
- Equipment failure caused by an accident
- Equipment failure caused by natural disasters including floods, earthquakes and lightning or other unavoidable circumstances.
- Equipment failure due to an unqualified person deforming, disassembling or repairing the equipment
- Equipment failure caused by using improper materials or parts
- Lubricating oil and consumable parts
- Damages incurred while the equipment is not in operation

**Notice**

For repair purposes, Lee Hwa Industry carries discontinued parts for 5 years.



이화산업사
LEE HWA INDUSTRY CO.

Lee Hwa Industry Co.

-
- 22-23, 2saneopdanji 3-gil, Waegwan-eup, Chilgok-gun, Gyeongsangbuk-do (303-7 Naksan-ri)
 - Website: www.lee-hwa.co.kr
 - Tel: +82 (0)54-975-5789
 - Fax: +82 (0)54-975-1882



KOREA AGRICULTURAL
MACHINERY INDUSTRY COOPERATIVE

Korea Agricultural Machinery Industry
Cooperative (KAMICO)

-
- 180, Jeongja 1-gil, Seonggeo-eup, Seobuk-gu, Cheonan-si, Chungcheongnam-do
 - Website: www.kamico.or.kr
 - Tel: +82 (0)41-411-2100
 - Fax: +82 (0)41-555-4491

The user manual contains a product warranty.